

**P S I E C**  
**GOINDWAL SAHIB**

**LAYOUT PLAN FOR INDUSTRIAL FOCAL POINT AT GOINDWAL SAHIB, PHASE -II.**

**TOTAL AREA OF SCHEME = 434.09 ACS.**

**PROPOSAL :-**

S. NO.	CATEGORY OF PLOT	AREA IN ACRES.	% OF AREA
01	RESIDENTIAL	107.00	24.82
02	COMMERCIAL	26.82	6.13
03	INDUSTRIAL	346.27	79.76
04	PUBLIC BUILDING, INCLUDING HR. SEC., SCHOOL & RELIGIOUS INSTITUTIONS	27.83	6.42
05	GREEN SPACE & PROPOSED ROADS	80.33	18.62
06	BUS STAND	4.76	1.09
07	ELECTRICITY / POWER HOUSE	1.74	0.40
<b>TOTAL</b>		<b>434.09</b>	<b>100 %</b>

**DETAIL OF PLOTS:- ( INDL. )**

S.NO.	CATEGORY OF PLOT	NO. OF PLOTS	AREA IN ACS.
01	80.00 ACS.	01	80.00
02	24.00 TO 35.00 ACS.	03	89.20
03	10.00 TO 20.00 ACS.	03	47.16
<b>TOTAL</b>		<b>07</b>	<b>216.36 ACS.</b>

**NOTE:-**  
CONCEPTUAL PLAN PREPARED ON THE BASIS OF SURVEY PLAN SUPPLIED BY GICO WIDE DRG. NO. 6 OF JOB NO. 4.  
CONCEPTUAL PLAN REVISED ON 10.03.92 IN LIGHT OF DISCUSSIONS OF XEN. GICO HELO WITH C.T.P (P.B) ON 9.3.92 REGARDING CHANGE OF BUS STAND SITE. REQUESTED WIDE XEN. GICO LETTER NO. GICO / BR-92 / 333. DT.26.2.92

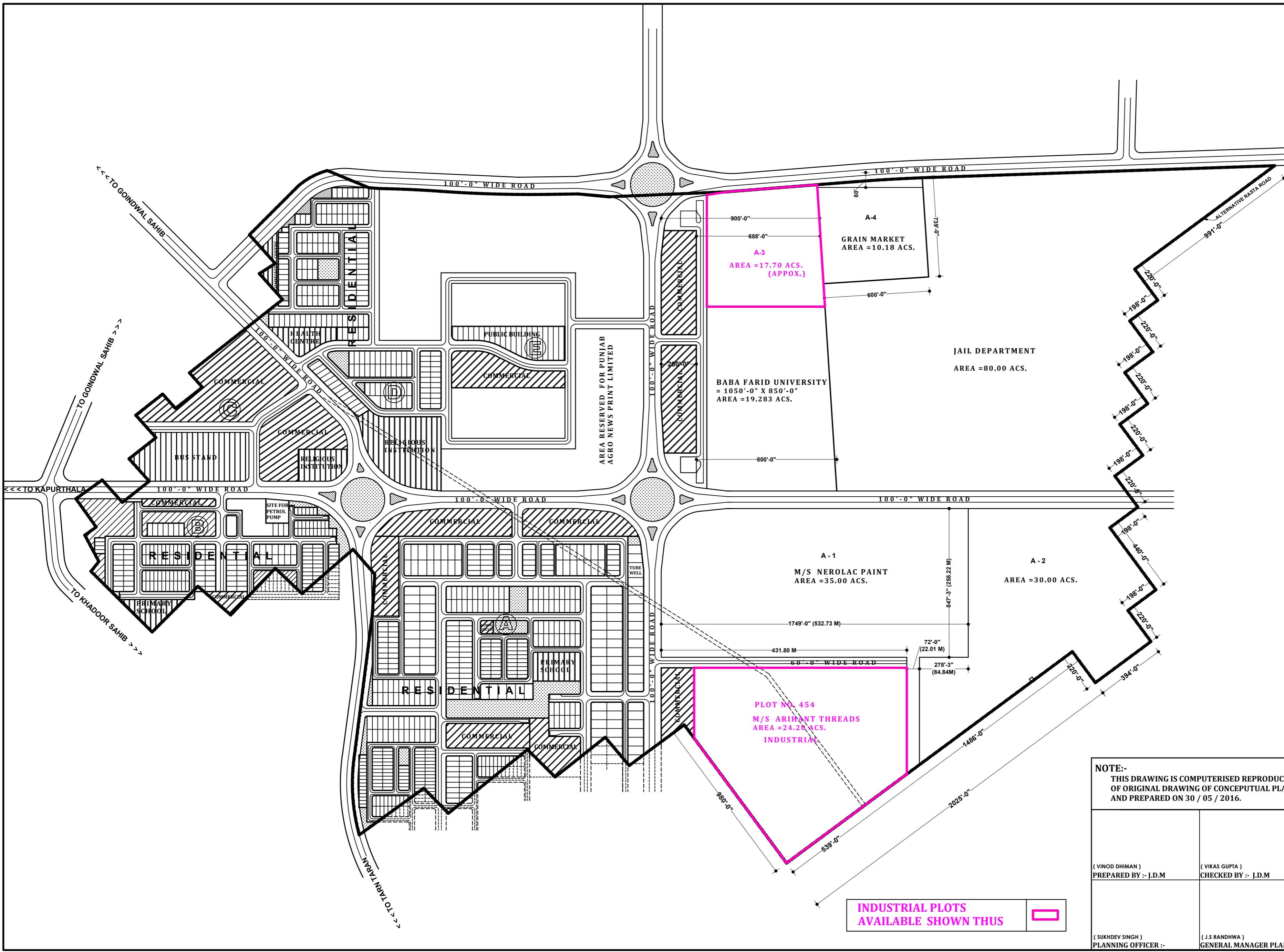

**INDUSTRIAL PLOTS AVAILABLE SHOWN THUS**

**NOTE:-**  
THIS DRAWING IS COMPUTERISED REPRODUCTION OF ORIGINAL DRAWING OF CONCEPTUAL PLAN AND PREPARED ON 30 / 05 / 2016.

(VINOD DHIMAN)  
PREPARED BY :- J.D.M

(VIKAS GUPTA)  
CHECKED BY :- J.D.M

(SUKHDEV SINGH)  
PLANNING OFFICER :-

(J.S RANDHWA)  
GENERAL MANAGER PLANNING

**OFFICE OF THE CHIEF ENGINEER, PUNJAB SMALL INDUSTRIES & EXPORT CORPORATION UDYOG BHAWAN, SECTOR:-17 CHANDIGARH.**

SCALE :- 220'-0" TO AN INCH