

P S I E C B A T A L A

LAYOUT PLAN FOR INDUSTRIAL FOCAL POINT AT BATALA.

TOTAL AREA OF THE SCHEME:-
= 104.00 ACS.

DETAIL OF PLOTS:- (INDL.)

S.NO	CATEGORY OF PLOT	NO. OF PLOTS	AREA IN ACS.
01	4.0 ACS. AND ABOVE PLOTS	02	10.85
02	1.0 ACS. AND ABOVE PLOTS	10	12.20
03	1/2 ACS. PLOTS	46	25.18
04	1/4 ACS. PLOTS	80	15.98
05	500 SQ. YARDS PLOTS	16	01.66
06			
TOTAL		154	65.87 ACS.

DETAIL OF AREAS:-

S. NO.	CATEGORY	AREA IN ACS.	% AGE
01	AREA UNDER INDUSTRIAL PLOTS	65.87	63.33
02	AREA UNDER COMMERCIAL USE	00.56	0.53
03	AREA UNDER RAW MATERIAL	02.40	2.30
04	AREA UNDER ROADS	15.63	15.02
05	AREA UNDER OPEN SPACE	12.30	11.82
06	AREA UNDER ELECT. SUB. STN.	04.06	3.90
07	AREA UNDER WATER WORKS	00.90	0.86
08	AREA UNDER DISPOSAL WORKS	01.26	1.21
09	RESERVED FOR PUBLIC HEALTH SERVICES (20'-0" STRIP)	00.32	0.30
10	AREA UNDER TESTING LAB	00.70	0.67
TOTAL		104.00 ACS.	100%

SALEABLE AREA

S.NO.	CATEGORY	AREA IN ACS.
01	AREA UNDER INDUSTRIAL PLOT	65.87
02	AREA UNDER COMMERCIAL (40 % OF 0.56 AREA)	0.22
TOTAL SALEABLE		66.09 ACS.
		63.54 %

**OFFICE OF
THE CHIEF ENGINEER,
PUNJAB SMALL
INDUSTRIES & EXPORT
CORPORATION UDYOG
BHAWAN, SECTOR:-17,
CHANDIGARH.**

SCALE:- 1/10" TO AN INCH	JOB NO. / DRG. NO.:- P-22 / LP-4 / 78
DATE:- 29-06-78	REV:-31.1.79, 5.9.80, 29.12.80
(S.D.SADHU) ASSTT. TOWN PLANNER:-	(V.KAS GUPTA) CHECKED BY:- I.D.M
(SUKHDEV SINGH) ASSTT. TOWN PLANNER:-	(GURDEEP SINGH) GENERAL MANAGER PLANNING
	EXECUTIVE ENGINEER
	CHIEF ENGINEER

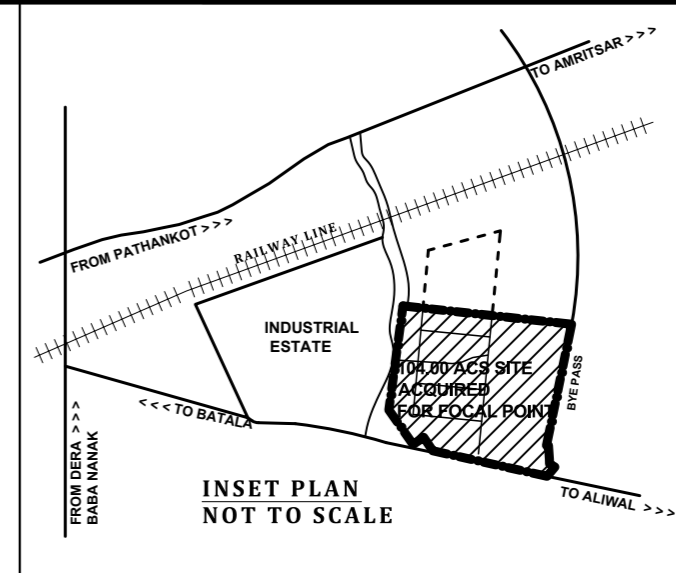

**THIS DRAWING SUPERSEDES ALL THE PREVIOUS DRAWINGS
DRAWING NO. P-22/LP-3/78. AND DRG. NO. P-22/LP-2/78 DATED 18-1-78**

- NOTE:-**
- 1) SALEABLE AREA INCLUDING AREA UNDER PLOTS PLUS 50% AREA OF COMMERCIAL USE AND AREA UNDER ELECTRIC SUB-STATION.
 - 2) FOR SET BACK LINES, SITE COVERAGE SEPARATE ZONING PLAN SHALL BE PREPARED SUSSSE QUENTLY.
 - 3) SITE FOR WATER WORKS AND DISPOSAL WORKS ARE TENTATIVE.
 - 4) LAY-OUT PLAN HAS BEEN MODIFIED TO EARMARKED THE SITE FOR 66 K.V. ELECTRIC SUB-STATION ON DATE 17.9.1979.

- NOTE:-**
- 1) LAY-OUT PLAN MODIFIED AS PER SURVEY SUBMITTED BY S.D.E.-XVI PSSIC MOGA VIDE LETTER NO. 2133, DATED 22-11-78
 - 2) PUMP CHAMBER STAFF QUARTERS AND MAINTENANCE OFFICE HAS BEEN MARKED ON THE PLAN ON DATED-16.2.1979.
 - 3) STANDARD DESIGN FOR STAFF QUARTERS SHALL BE AS PER THIS OFFICE DRG. NO STD/ STAFF QUARTER/PH-1/76.
 - 4) STANDARD DESIGN FOR P.H. FOR CHLORINATION CHAMBER AND TUBE WELL SHALL BE FOLLOWED.
 - 5) FOR THE ARCHITECTURAL DETAILS OF MAINTENANCE OFFICE REFER DRG. NO. MIISC./OFFICE-3/78, DATED 21.7.78.
 - 6) POSITION OF O.S.H.R. AND TUBE WELL IS MARKED AS PER DRAWING SUPPLIED BY S.D.E.-IV/ P.S.S.I.C. VIDE HIS LETTER NO. S.D.E 4/577, DATED 5.3.79.
 - 7) ON ACCOUNT OF SAMADHI ON PLOT NO. 79. THE LAY-OUT PLAN HAS BEEN MODIFIED TO CONVERT THE SAME INTO GREEN BELT ON DATED-5.9.80.
 - 8) AS DISCUSSED WITH MANAGING DIRECTOR AND CHIEF ENGINEER, THE BIGGER PLOT NO. 1, 2&3 MEASURING AROUND 22.50 ACRES HAS BEEN CONVERTED INTO SMALLER PLOT NO 95TO124, DATED OF AMENDMENT 29.12.80.
 - 9) SITE FOR COAL INDIA LIMITED HAS BEEN REDUCED FROM 3 ACRES TO 2 ACRES ON THERE REQUEST VIDE THEIR LETTER NO. CIL/CMO/CHD DUMP/986, DATED 22.6.82, AND AS PER THE ORDER OF MD / P.S.S.I.C.
 - 10) AS PER ORDER OF M.D. DATED 30.9.16 PLOT NO. 1-B MEASURING 2.90 ACS. CONVERTED INTO 1000 SQ. YARDS PLOTS NUMBERED AS 139 TO 154.

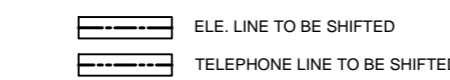

**INDUSTRIAL PLOTS
AVAILABLE SHOWN THUS**

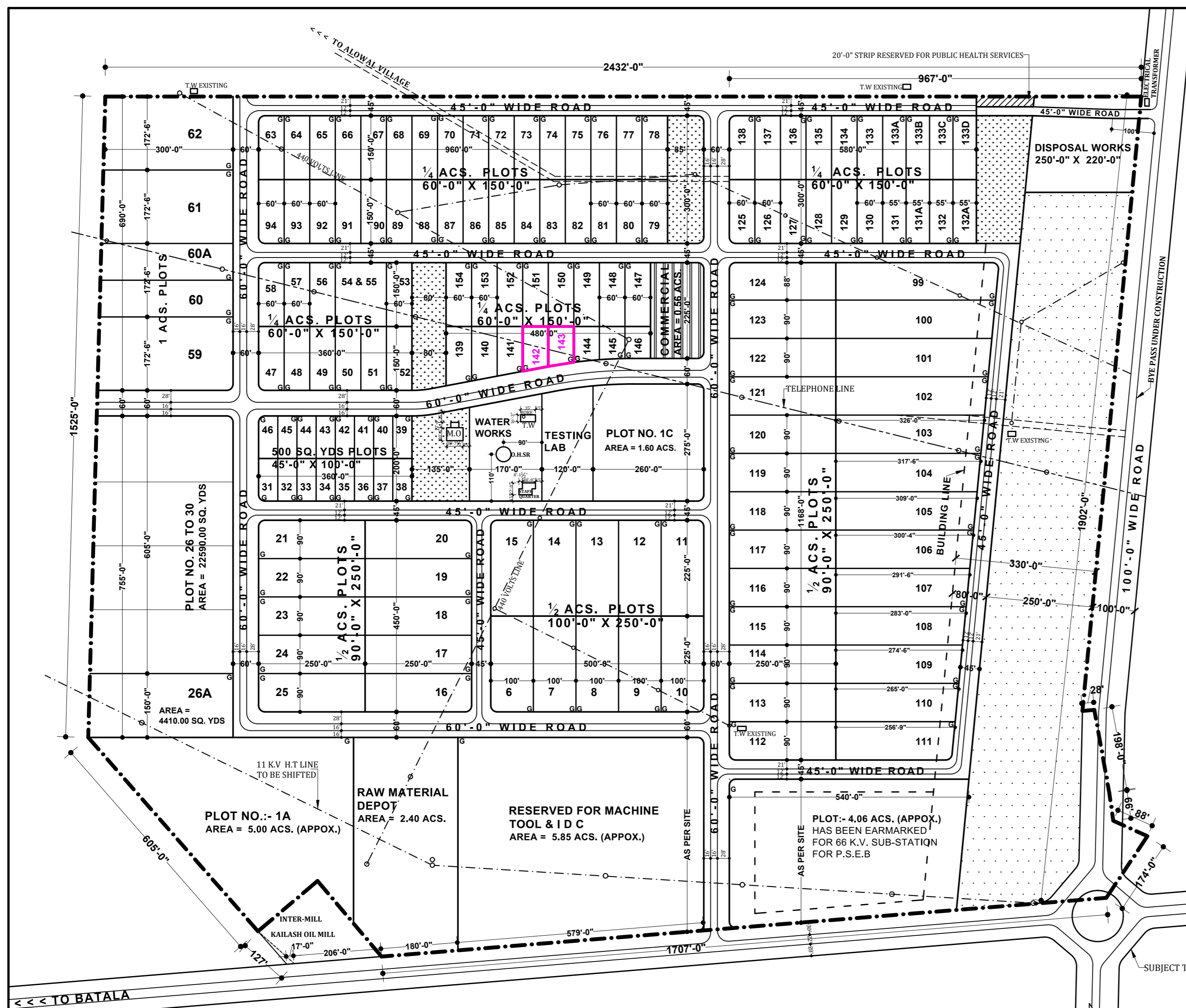

NOTE:-

PLOT NO 131,131/A, 132,132/A, 133/A,133/B,133/C AND 133/D (1000 SQ. YARDS) HAS BEEN CARVED OUT IN THE PLACE OF PLOT NO 131 AND 132(3750 SQ. YARDS) AS PER DECISION OF STANDING COMMITTEE HELD ON 22.9.1997.

AS PER DECISION TAKEN IN THE LAY-OUT PLAN APPROVAL COMMITTEE MEETING HELD ON 4.7.2013, APPROCHED ROAD FROM BYE-PASS TO FOCAL POINT CARVED OUT IN LAY-OUT PLAN ADJOINING DISPOSAL AREA.

PLOT NO-5B HAS BEEN CARVED OUT FROM DEPOT SITE ON 6.2.1984, AFTER MAKING THE DEPOT LAY-OUT.

AS PER DECISION OF ALLOTMENT COMMITTEE HELD ON 5.5.1995, THE 1000 SQ. YARDS PLOT (125 TO 130, 133TO138) AND 3/4 ACRES PLOT NO (131& 132) HAS BEEN CARVED OUT IN PLACE OF PLOT NO 95 TO 98(98 ACRES).

RESIDENTIAL POCKET ADJOINING PLOT NO. 4 CONVERTED INTO INDUSTRIAL PLOT MEASURING 5.00 ACRES AND RAW MATERIAL DEPOT 2.40 ACRES. AS PER DECISION TAKEN IN LAY-OUT PLAN APPROVAL COMMITTEE MEETING HELD ON 12.6.14.

AS PER THE DECISION TAKEN IN THE MEETING OF PLAN APPROVAL COMMITTEE HELD ON 8.7. 2014, THE RESIDENTIAL POCKET ADJOINING COMMERCIAL AREA CONVERTED INTO INDUSTRIAL PLOT MEASURING 2.90 ACRES, NUMBERED AS 1-B AND RESIDENTIAL POCKET ADJOINING TESTING LAB. ALSO CONVERTED IN THE INDUSTRIAL PLOT MEASURING 1.60 ACRES, NUMBERING AS 1-C.

DIMENSION OF THE PLOT NO 99 TO 111 HAS BEEN MARKED (AS PER SITE) GIVEN BY XEN.6, VIDE HIS LETTER NO 134/13.8.82.

AS PER ESTIMATE APPROVAL COMMITTEE MEETING HELD ON 18.12. 2002, THE SALEABLE AREA HAS BEEN INCREASED BY CONVERTING 8 MARLA TO 10 MARLA PLOTS.

NOTE:-
THIS DRAWING IS COMPUTERIZED REPRODUCTION OF ORIGINAL JOB NO. / DRG. NO. P-22 / LP-4/78, DATED, 29-06-78 AND PREPARED ON 20/06 / 2017.